

NOTE : Insulation fixings below DPC not shown for clarity

- ① Permarock Insulation (type and thickness to specification) on Permarock Adhesive
- ② Permarock Insulation Fixing
- ③ Permarock Bedding Mortar incorporating Permarock Reinforcing Mesh
- ④ Permarock Silicone^{ULTRA} K-Finish 1.5 mm
- ⑤ DPC
- ⑥ Permarock PVCu Transition Bead BEA/LW-66-2 for thin render
- ⑦ Proprietary fully bonded waterproof coating/DPM or Permarock BituCoat Adhesive Coating scratchcoat layer
- ⑧ Permarock CT114 Bituminous Adhesive Coating
- ⑨ Permarock EPS 200 (Thickness to provide min 75% of thermal resistance of main wall insulation) on Permarock CT114 Bituminous Adhesive Coating
- ⑩ Proprietary Drainage Sheet

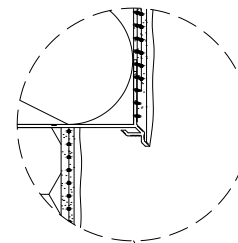

Alternate Transition Bead BEA-LW-206

Other corresponding component parts include:

BEA/LW-Z61H connector bar 1000 mm long (to be cut down on site to suit site requirements)

BEA/LWZ18-2A uPVC external corner section for use with BEA/LW-66-2 finishing/transition beads

BEA/LWZ18-2I uPVC internal corner section for use with BEA/LW-66-2 finishing/transition beads

BEA/LWZ18-4A uPVC external corner section for use with BEA/LW-66-4 finishing/transition beads

BEA/LWZ18-4I uPVC internal corner section for use with BEA/LW-66-4 finishing/transition beads

BEA/LW-L-50/2 uPVC L set-up profile - 50 mm wide (comes complete with connection peg - 1 per length) for use with BEA-LW-206

BEA/LW-L-100/2 uPVC L set-up profile - 100 mm wide (comes complete with connection peg - 1 per length) for use with BEA-LW-206

Where applicable all dimensions and details should be read in conjunction with specialist consultants drawings and the project specification.

All dimensions should be checked on site by the contractor and any discrepancies should be brought to the attention of Permarock Products Ltd.

This drawing is the copyright of Permarock Products Ltd. It shall not be copied to any other third party without the express written consent of Permarock Products Ltd.

DISCLAIMER: Whilst this information/document/proposal (together "Information") is based on the latest manufacturer facts and findings of which we are aware, we are not engaged as a designer or other contractor in respect of your project and so the information is general in nature and we cannot guarantee that any information provided meets all of your specific project requirements. Given this, we cannot guarantee that any products selected, specified and/or purchased by you and their proposed applications are fit for the intended purpose. Any specification or purchase by you is at your own risk and we recommend the information be reviewed and approved by an appropriately qualified professional prior to specification or purchase. Without prejudice to the generality of the foregoing, you (or the appropriately qualified professional from whom you seek advice) shall ensure that any performance criteria and/or coverage rates quoted can be achieved in each instance when compiling or pricing specific projects. To the extent permitted by law, Permarock will not be liable (whether in contract, tort (including negligence), breach of duty, misrepresentation or otherwise) for any loss or liability (of whatsoever kind) arising out of or in connection with any information we may provide.

Notes :

Rev	Date	Amendments	By	Approved



Permarock Products Ltd.
 Jubilee Drive
 Loughborough
 Leicestershire
 LE11 5TW
 Tel: (01509) 262924
 Email: permarock@permarock.com
 Web: www.permarock.com

Client : -

Project : PAS 2030/2035: 2019 Compliant Projects

Project Ref : -

Title : Insulated Plinth (SUK15)

Drawn By : HN Approved By : RWT

Date : 15/05/2025 Original Size : A3

Scale : NTS

Drawing No : PAS-B001 Rev.